



Invasive Plant Control at North Chagrin Reservation

Board Highlight, August 15, 2024

Jennifer Hillmer
IPM Coordinator
Natural Resources Division

Invasive plant removal sites

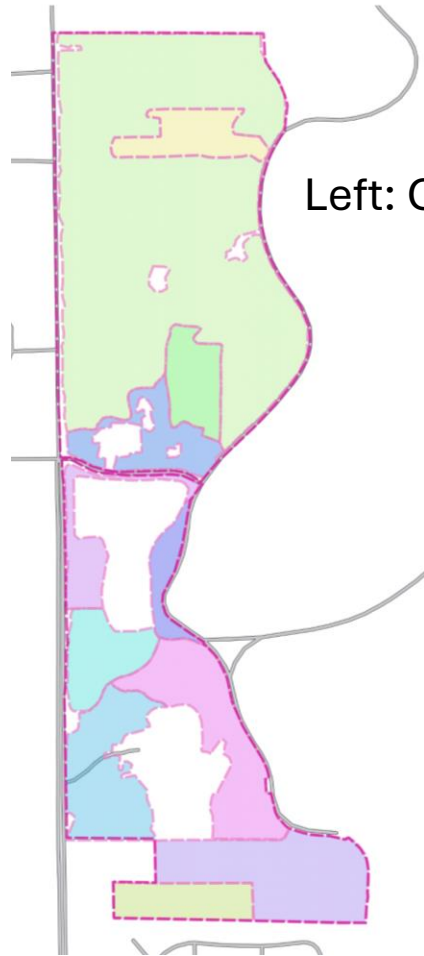

Left: Contractor sites (200 A)



Right: Cleveland Metroparks sites (30 A)

Land use history

Strawberry Lane

Sunset Lane

St. Bartholomew Church



Strawberry Lane

Sunset Lane

St. Bartholomew Church

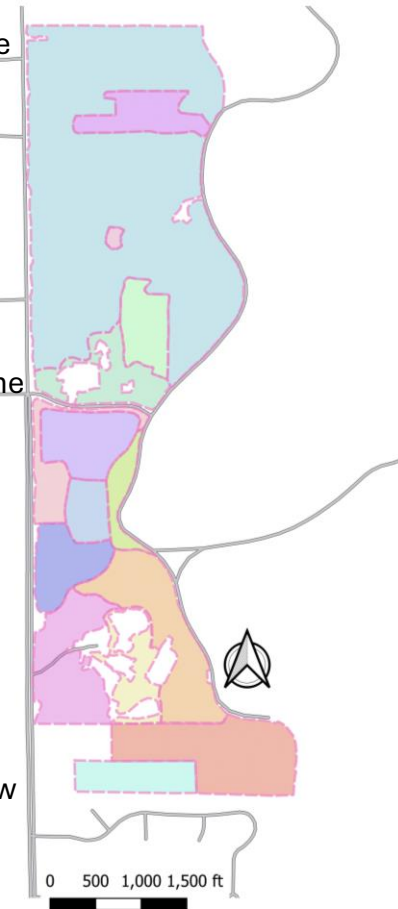

Drainage ditches and tiles



Vernal pool construction



Disruption of drainage



Invasive plant management within restoration projects



This Old Habitat: before, during & after renovation

- Before: clean up the proposed work site
- During: keep the work site and surroundings tidy and safe
- After: Check for problems, follow-up quickly, maintain the new conditions

Goal and objectives



GOAL: Work with the natural resilience of the ecosystem to support regrowth and reestablishment of native habitats.

OBJECTIVE 1: Decrease pressure from invasive plants within the project site.

Extent of invasive plant populations

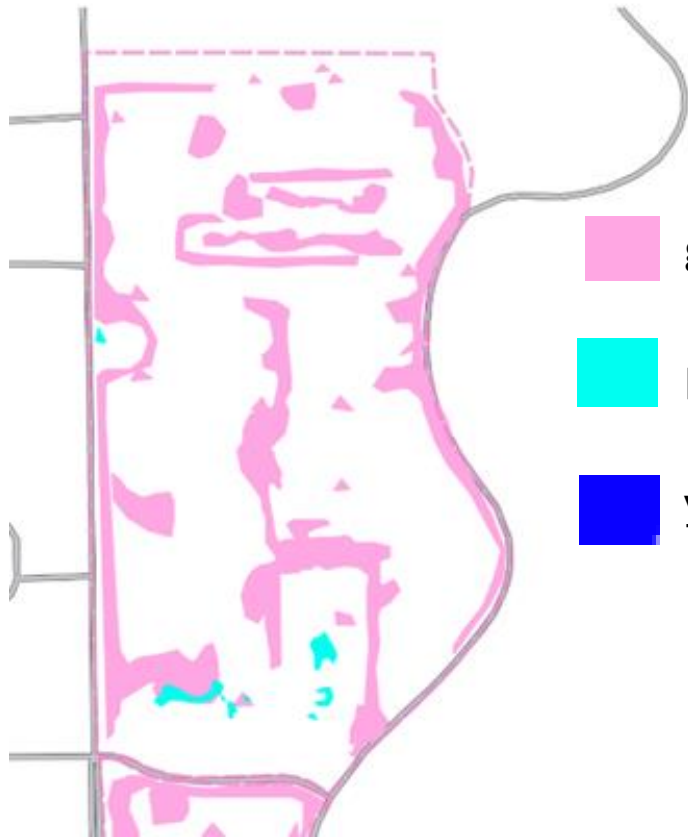
North of Sunset Lane



-  glossy buckthorn
-  purple loosestrife
-  yellow flag iris

South of Sunset Lane



Goal and objectives

GOAL: Work with the natural resilience of the ecosystem to support regrowth and reestablishment of native habitats.

OBJECTIVE 1: Decrease pressure from invasive plants within the project site.

OBJECTIVE 2. Increase native plant recovery from the seedbank or from native plant stock already present within the site.

Native sedge seed collection



Habitats: forest edge & meadow



Chris

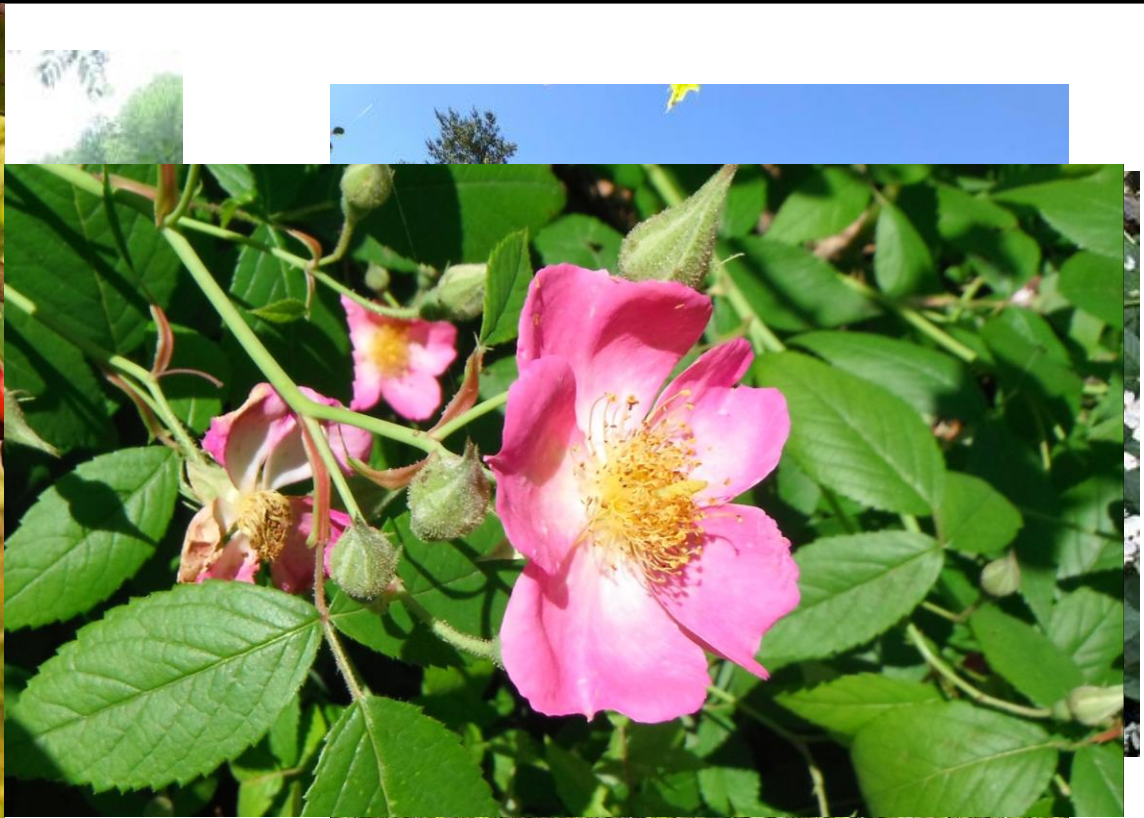

wood.org



Habitats: marsh and wet meadow



USDA, NRCS. 2024. PLANTS Database National Plant Data Team, Greensboro, NC.

Habitats: forest mosaic



Minnesota Wildflowers.info

Per Verdonk CC BY-NC 2.0

A few of my favorite things

